



Safety Coupling I Series SKY-ES for direct drives

// with elastomer attachment for direct drives // with conical clamping hub
 // plug-in // backlash-free // flexible // robust // oscillation dampening

technical data:

SKY -ES size	setting range disengagement torque T_{KA} [Nm]	moment of inertia [10^{-3}kgm^2]	mass approx. [kg]	torsional stiffness [Nm/arcmin]	max. shaft alignment [mm] axial \pm lateral	tightening torque of screws f [Nm] i [Nm]	\varnothing D1 min max	\varnothing D2 min max
6	2 - 6						9 19	5 11,5
12	6 - 12	0,13	0,5	0,25	0,5 0,1	6xM4-4 M3-1.5	9 19	5 11,5
15	8 - 15						12 26	9 17
30	13 - 30	0,5	1,0	1,0	0,5 0,1	4xM5-8 M4-3	12 26	9 17
45	22 - 45						12 26	10 17
60	25 - 60						12 36	12 24
100	40 - 100	1,4	1,9	1,2	1 0,1	8xM5-8 M6-12	12 36	12 24
150	60 - 150						14 36	14 24
230	80 - 230	5,5	4,3	3,6	1 0,12	4xM8-35 M6-12	19 40	18 35
330	130 - 330	18,5	8,8	8	1 0,15	4xM12-115 M8-30	19 40	22 35
500	200 - 500	57	16	12	1 0,1	4xM12-115 M12-90	25 60	28 42
800	350 - 800	102	25,6	21	1 0,15	8xM12-115 M12-90	28 60	30 42
1000	500 - 1000						35 60	40 65
2000	800 - 2000						35 85	40 65

material:

safety part: heat-treated steel

hub: high-tensile aluminum

(size 2000: tempered steel)

clamping ring: heat treated steel

elastomer spider: polyurethane – 98 Shore A

screws: ISO 4762 / 12.9

temperature range: -30°C up to +90°C

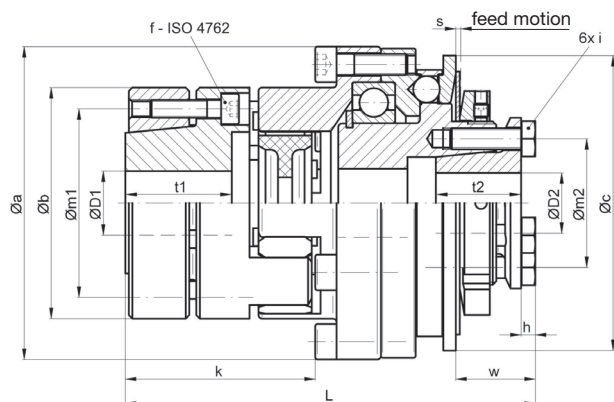

Dimensions [mm]: length dimensions according to DIN ISO 2768 cH

SKY-ES	$\varnothing a$	$\varnothing b$	$\varnothing c$	h	k	$L \pm 1$	$\varnothing m1$	$\varnothing m2$	s	t1	t2	w
6/12	52,5	40	48	3	41	83	31	19	0,9	21	15	14
15/30/45	69	55	66	4	48	100	43	27	1,2	25	18	18
60/100/150	88	65	83	4	53,5	115,5	53	36	1,6	30	24	22
230/330	115	80	109	4	68	145,5	64	50	1,8	40	27	24
500/800	137	120	132	5,3	94	187	96	62	2,5	54	32	33
1000	181	120	185	7,5	95	218	96	98	3,7	54	45	64,5
2000	181	160	185	7,5	114	236,5	130	98	3,7	66	45	64,5

Note: elastomer spider optionally available with alternative shore hardness
coupling side with lateral clamping hub, see series SKY-EK

order example: SKY-ES 230 - D1 = 33 H7 - D2 = 28 H7 - T_{KA} = 200 Nm